

Specifications

- Wi-Fi adaptor to allow remote control and monitoring of Samsung DVM S indoor units (AM****N***/AA), single zone CAC systems (AC0***N****/AA), and FJM systems with Slim Duct, cassette, and/or console units connected (AJ0**T*****/AA, AJ0**B*****/AA) from a mobile device (Android or iOS) via SmartThings app available on Google Play or iTunes app stores.
- System Connectivity
 - Single Wi-Fi adaptor to control and monitor up to 16 indoor units across multiple systems
 - Maximum 16 Wi-Fi adaptors for single DVM S system (control up to 64 indoor units)
 - S-Convertor and SNET Pro 2 service software required to configure connection of multiple Wi-Fi-adaptors to DVM S systems
- User Accounts
 - Maximum 200 accounts, Wi-Fi adaptor quantity per account: 200 units
- Features and Functions
 - Control and monitor indoor unit (individual/group/scene): power status, mode, set temperature, room temperature, fan speed, and supply air louver position
 - Individual power monitoring up to 16 outdoor units (outdoor module can be monitored)
 - Power consumption trend (daily/weekly/monthly)¹
 - 7 Day scheduling for a single unit or multiple indoor units
 - Logic control with automation
 - Geo-fencing capable
 - Voice control via mobile device (compatible with Bixby2.0 and above and other voice control services)
 - Firmware update by using Micro SD card
- Operating Conditions
 - Ambient temperature range: 32 ~ 104°F (0 ~ 40°C)
 - Relative humidity range: 30 ~ 90%



Connection

- 4 wire connection to an indoor unit (F1/F2, V1/V2)
- 12VDC supplied by indoor unit (V1/V2)
- Can be used along with other Samsung central control options
- Requires a local Wi-Fi router with DHCP enabled and an internet connection
- Wi-Fi communication: 802.11b, g, n (2.4 GHz and 5 GHz supported)
- Mobile device must be on the local network for initial Wi-Fi adapter configuration and connection

¹Energy consumption data is for general reference only and should not be used for billing purposes. Data provided will not necessarily match your utility bill. Not all indoor models support energy consumption data.

Dimensions

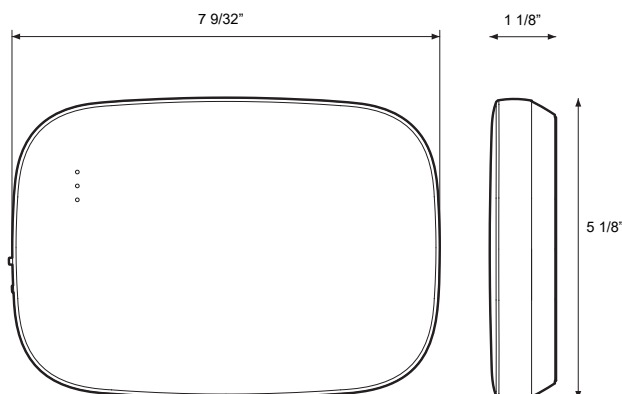

Connecting to DVM S Systems*

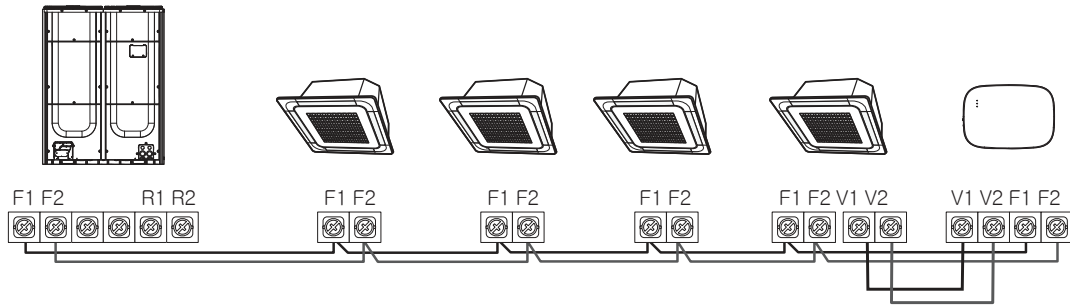

Connecting to CAC Systems*

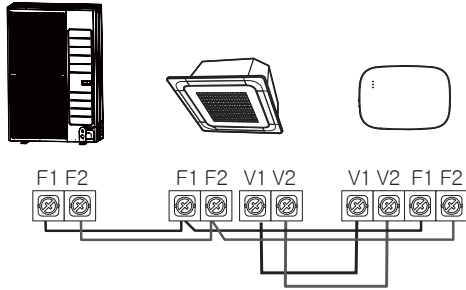

Connecting to Multiple Systems

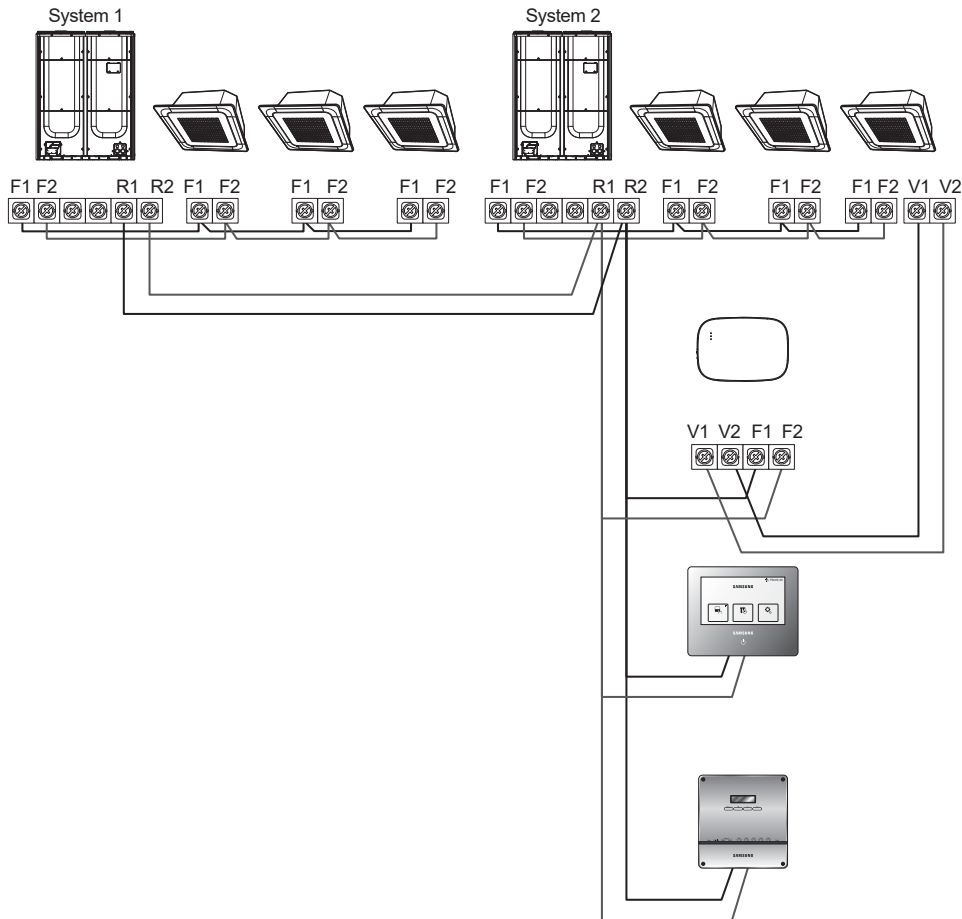

Connecting multiple MIM-H04UN Wi-Fi Adapters to a Single DVM S System

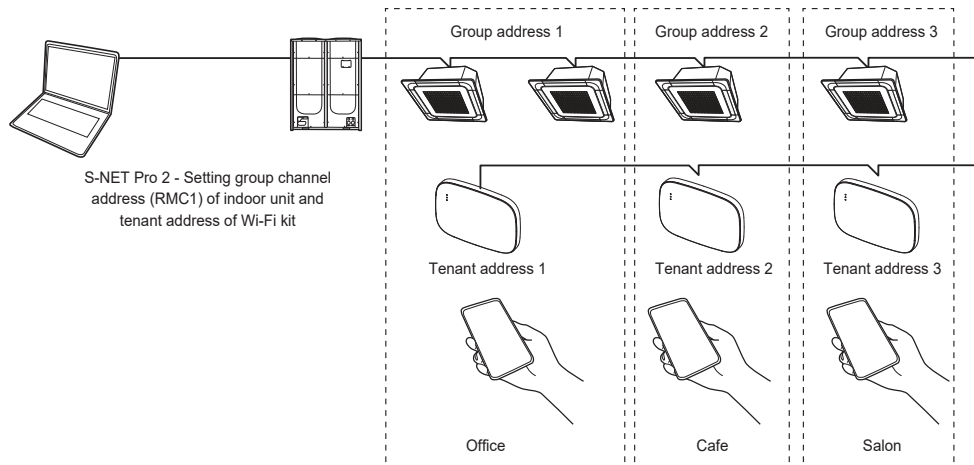

Network Communication Diagram*

